

Society Street - Lane Closure and Diversion

Phase 1H

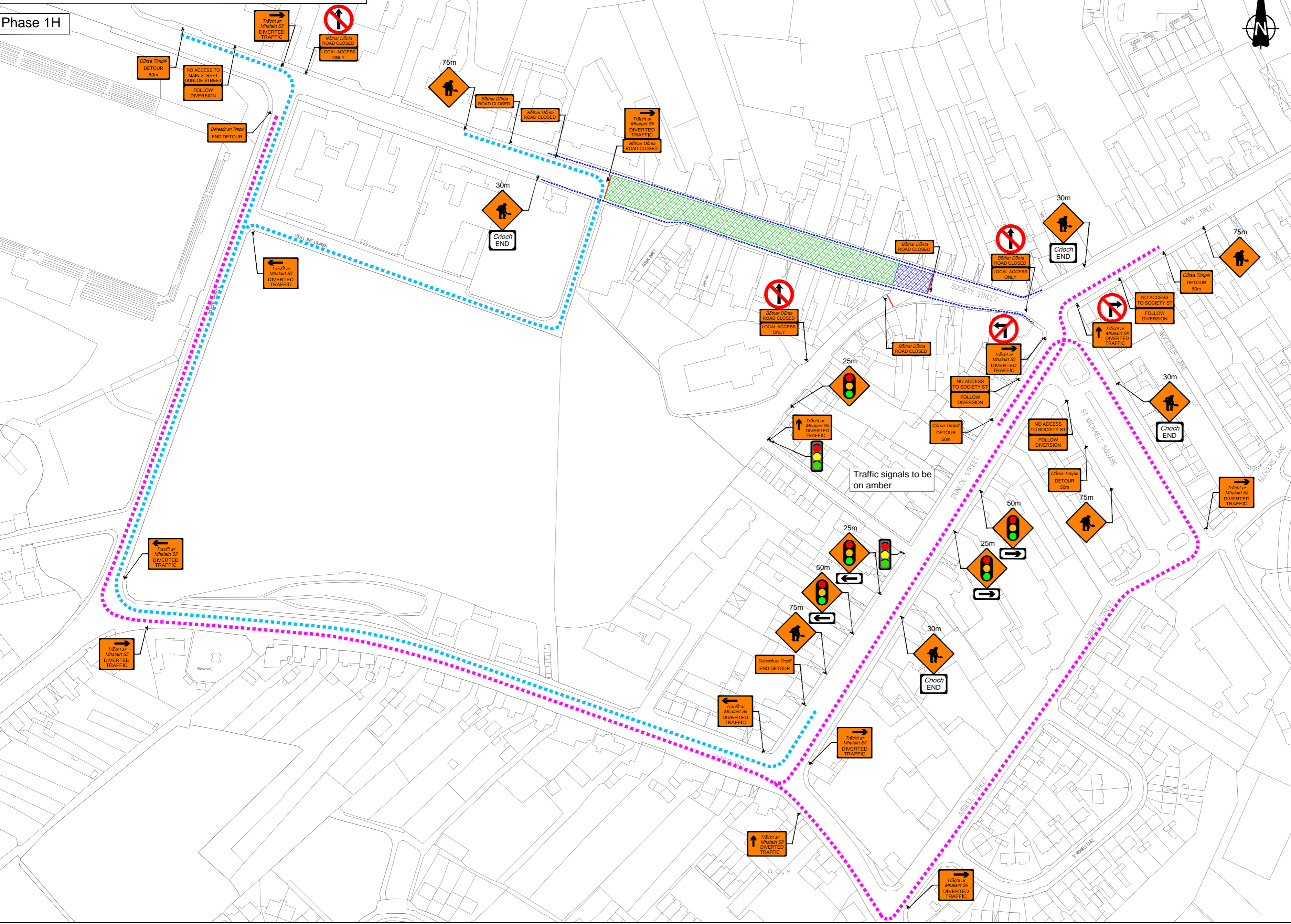

Designs Parameters:
Type A, Level 2, Speed limit 50/60km/h.

Design Parameters	Roadworks Type A (Full-Time)	Roadworks Type B (Part-Time)	Roadworks Type C (Short Duration)
Speed Limit	50 or 60 km/h		
Temporary Signs			
Sign Visibility (m)	50	50	50
Number of Signs	3	2	2
Cumulative Distance (m)	75	50	50
Distance between advance signs (m)	25	25	25
Minimum Rate of Taper			
Taper at Lane (m)	1 in 15	1 in 5	1 in 5
Taper at Hard Shoulder (m)	1 in 10	1 in 5	1 in 5
Maximum Lamp Spacing			
At Taper (m)	6	6	6
Longitudinal (m)	12	12	12
Maximum Cone Spacing			
At Tapers (m)	3	3	3
Longitudinal (m)	6	6	6
Cone Height (mm)	750	750	750
Safety Zone			
Longitudinal (m)	25	5	5
Lateral (m)	0.5	0.5	0.5
Minimum Lane Width			
Min Lane Width (m)	3.0	3.0	3.0

- General Notes:**
1. All signs to be in accordance with Chapter 8 of TSM Guidance Document.
 2. Signs to be placed so as not to cause obstruction to road users and pedestrians.
 3. Safety Zones to be in accordance with Chapter 8 and maintained at all times.
 4. An Garda Siochana to be notified prior to works commencing.
 5. Any changes to TM Plan undertaken on site must be communicated to and approved by PSCS and PSDP.
 6. Minimum 3.00m lane width to be maintained at all times.

Site Specific Notes:

Traffic signals to be on amber

Legend:

- Works Area
- Diversion Route
- Pedestrian Route
- Sign Symbol

Ordnance Survey Ireland Licence No. EN 0063609
 t ÁÚi)á) & ÁÚ' i c^ ÁÚ'á) áÚ) (c^i) (^) ó ÁÚ'á) á

SIAC
 Dolcain House, Monastery Road
 Clondalkin, Dublin 22
 T: +353 (0)1 403 3111
 F: +353 (0)1 403 3222
 Email: info@siac.ie
 Web: www.siac.ie

Client:

Project Title:
Ballinasloe Water Services Upgrade Contract No.2 and Street Enhancement Works

Drawing Title:
Temporary Traffic Management Layout For Lane Closure and Diversion Society Street, Middle Phase 1H

Revision Details Box

Rev. No.	Comments

Detail Box

Drawn:	Scale:	Drawing no.:
PB	not to scale	TMD/2017/ET018
Approved:	Date:	Rev:
PMC	30.11.2018	0