

# Main Street - Road Closure and Diversion



Designs Parameters:  
Type A, Level 2, Speed Limit 50/60km/h

Design Parameters	Roadworks		Roadworks	
	Type A	Type B	Type A	Type B
Speed Limit	50	60	50	60
Signage	W1, W2, W3, W4, W5, W6, W7, W8, W9, W10, W11, W12, W13, W14, W15, W16, W17, W18, W19, W20, W21, W22, W23, W24, W25, W26, W27, W28, W29, W30, W31, W32, W33, W34, W35, W36, W37, W38, W39, W40, W41, W42, W43, W44, W45, W46, W47, W48, W49, W50, W51, W52, W53, W54, W55, W56, W57, W58, W59, W60, W61, W62, W63, W64, W65, W66, W67, W68, W69, W70, W71, W72, W73, W74, W75, W76, W77, W78, W79, W80, W81, W82, W83, W84, W85, W86, W87, W88, W89, W90, W91, W92, W93, W94, W95, W96, W97, W98, W99, W100	W1, W2, W3, W4, W5, W6, W7, W8, W9, W10, W11, W12, W13, W14, W15, W16, W17, W18, W19, W20, W21, W22, W23, W24, W25, W26, W27, W28, W29, W30, W31, W32, W33, W34, W35, W36, W37, W38, W39, W40, W41, W42, W43, W44, W45, W46, W47, W48, W49, W50, W51, W52, W53, W54, W55, W56, W57, W58, W59, W60, W61, W62, W63, W64, W65, W66, W67, W68, W69, W70, W71, W72, W73, W74, W75, W76, W77, W78, W79, W80, W81, W82, W83, W84, W85, W86, W87, W88, W89, W90, W91, W92, W93, W94, W95, W96, W97, W98, W99, W100	W1, W2, W3, W4, W5, W6, W7, W8, W9, W10, W11, W12, W13, W14, W15, W16, W17, W18, W19, W20, W21, W22, W23, W24, W25, W26, W27, W28, W29, W30, W31, W32, W33, W34, W35, W36, W37, W38, W39, W40, W41, W42, W43, W44, W45, W46, W47, W48, W49, W50, W51, W52, W53, W54, W55, W56, W57, W58, W59, W60, W61, W62, W63, W64, W65, W66, W67, W68, W69, W70, W71, W72, W73, W74, W75, W76, W77, W78, W79, W80, W81, W82, W83, W84, W85, W86, W87, W88, W89, W90, W91, W92, W93, W94, W95, W96, W97, W98, W99, W100	W1, W2, W3, W4, W5, W6, W7, W8, W9, W10, W11, W12, W13, W14, W15, W16, W17, W18, W19, W20, W21, W22, W23, W24, W25, W26, W27, W28, W29, W30, W31, W32, W33, W34, W35, W36, W37, W38, W39, W40, W41, W42, W43, W44, W45, W46, W47, W48, W49, W50, W51, W52, W53, W54, W55, W56, W57, W58, W59, W60, W61, W62, W63, W64, W65, W66, W67, W68, W69, W70, W71, W72, W73, W74, W75, W76, W77, W78, W79, W80, W81, W82, W83, W84, W85, W86, W87, W88, W89, W90, W91, W92, W93, W94, W95, W96, W97, W98, W99, W100

### General Notes:

- All signs to be in accordance with Chapter 6 of TSM Guidance Document
- Signs to be placed so as not to cause obstruction to road users and pedestrians
- Safety Zones to be in accordance with Chapter 8 and maintained at all times
- An Garda Síochána to be notified prior to works commencing
- Any changes to TM Plan undertaken on site must be communicated to and approved by PSCS and PSDP
- Minimum 3.00m lane width to be maintained at all times

### Site Specific Notes:

- Legend:
- Work Area
  - Diversion Route
  - Traffic Cones
  - Pedestrian Route
  - Sign Symbol

Ordinance Survey Ireland Licence No. EN 00636039

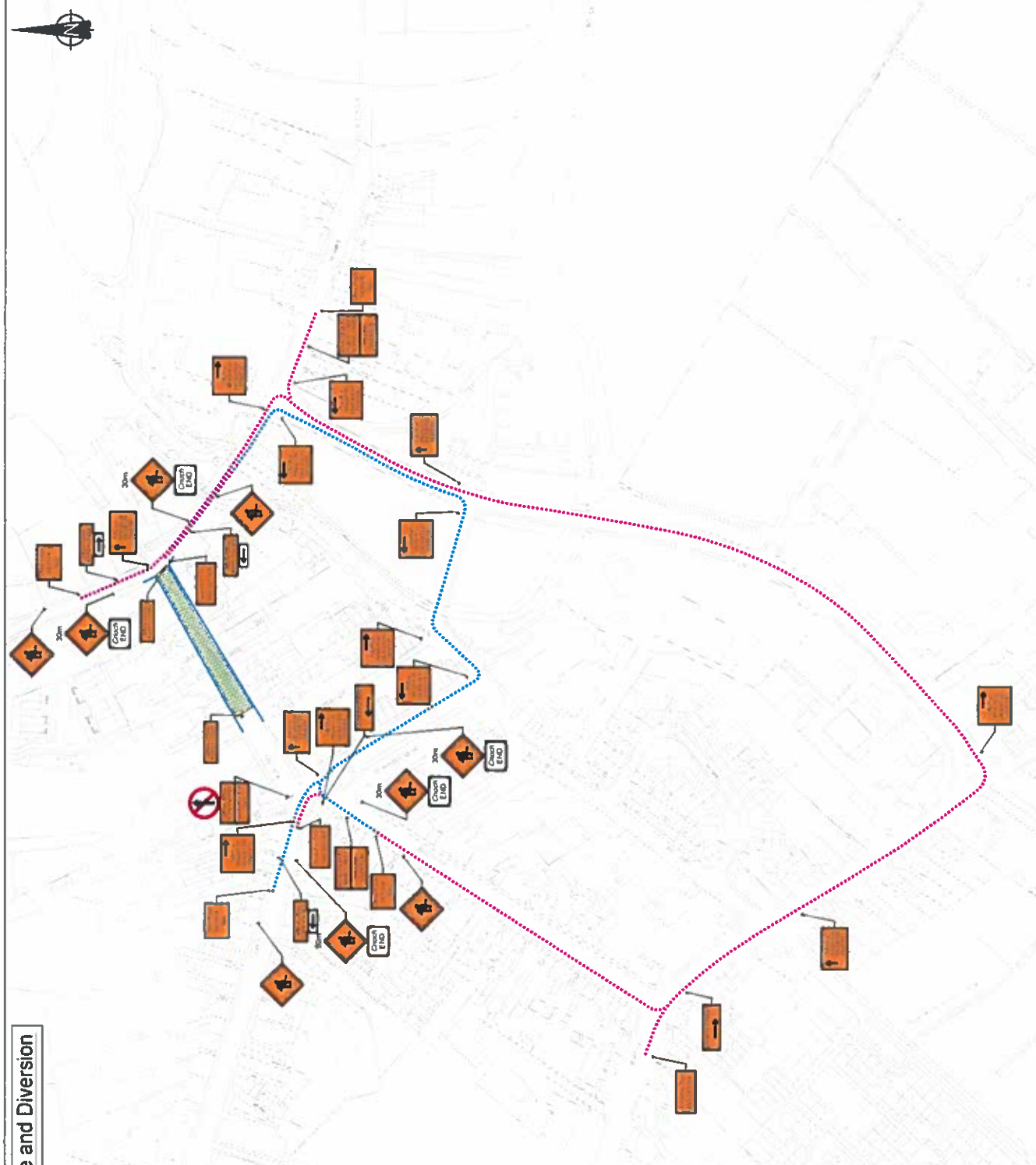

SIAC  
Doosan House, Monastery Road  
Clonsilla, Dublin 22  
T: +353 (0)1 403 3111  
F: +353 (0)1 403 3222  
E: [info@siac.ie](mailto:info@siac.ie)  
Web: [www.siac.ie](http://www.siac.ie)



Client:  
**Ballinacree Water Services Upgrade  
Contract No. 2 and Street  
Enhancement Works**

Drawing Title:  
**Temporary Traffic Management Layout  
For Road Closure and Diversion  
Main Street**

Revision Details Box

Rev.	No.	Comments

Detail Box

Drawn	PB	Scale	not to scale	Drawing no	TMD/2017/ET/033
Approved	SS	Date	22.05.2018	Rev	0

**Main Street - Lane Closure and Diversion**

**Design Parameters**  
Type A, Level 2, Speed limit 50/60km/h

Design Parameter	Parameters		Subsidence Type
	Type A	Type B	
Maximum Allowable Depth (m)	0.5	0.5	30
Maximum Allowable Diameter (mm)	75	150	3
Maximum Allowable Length (m)	24	24	20
Maximum Allowable Number of Installations	1.0/1.0	1.0/1.0	1.0/1.0
Maximum Allowable Distance Between Installations (m)	6	6	10
Maximum Allowable Depth (m)	0.5	0.5	30
Maximum Allowable Diameter (mm)	75	150	3
Maximum Allowable Length (m)	24	24	20
Maximum Allowable Number of Installations	1.0/1.0	1.0/1.0	1.0/1.0
Maximum Allowable Distance Between Installations (m)	6	6	10

**General Notes:**

1. All signs to be in accordance with Chapter 8 of TSM Guidance Document.
2. Signs to be placed so as not to cause obstruction to road users and pedestrians.
3. Safety Zones to be in accordance with Chapter 8 and maintained at all times.
4. An Garda Siochana to be notified prior to works commencing.
5. Any changes to TM Plan undertaken on site must be communicated to and approved by PSCS and PSOP.
6. Minimum 3.00m lane width to be maintained at all times.

**Site Specific Notes:**



- Legend:**
- Works Area
  - Diversion Route
  - Traffic Cones
  - Pedestrian Route
  - Sign Symbol

Drawn	Scale	Drawing no.
PB	not to scale	TMD2017/ET032
Approved	Date	Rev
SS	22.05.2019	0

Ordnance Survey Ireland Licence No. EN 000000000

**Revision Details Box**

REV. NO.	Comments

**Drawing Title:** Temporary Traffic Management Layout For Lane Closure and Diversion Main Street

**Project Title:** Ballinasloe Water Services Upgrade Contract No. 2 and Street Enhancement Works

**Client:** SIAC  
 Dolcan House, Monastery Road, Clondallin, Dublin 22  
 P: +353 (0)1 403 3111  
 F: +353 (0)1 403 3122  
 Email: info@siac.ie  
 Web: www.siac.ie

