

DIVERSION ROUTE PHASE 2

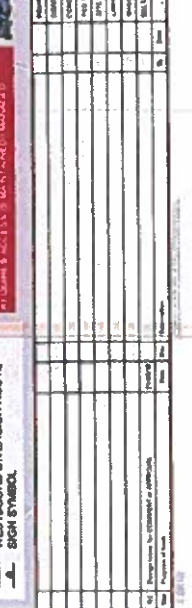

Client	Project Name	Project No.	Scale	Date	Version
18 032	SHARERIDGE				
19 AF012	TUAM RWSS				
<p>TRAFFIC MANAGEMENT DESIGN LTD Unit 13, Merrimack Shopping Centre, Church Street, Carristown, Co. Clare, Ireland. Tel: 087 277388 Fax: 087 277389 Mobile: +353 (0) 86 042500 Web: www.tmd.ie Email: road@tmd.ie</p>					
<p>SHARERIDGE PIPE REPLACEMENT SPECIALISTS</p>					
<p>TEMPORARY TRAFFIC MANAGEMENT LAYOUT FOR ROAD CLOSURE TO FACILITATE PIPELINE ROUTE ON THE L-4253 AT SEEFIN, CRAUGHWELL, CO. GALWAY (PHASE 2)</p>					

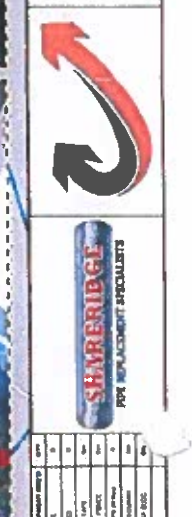
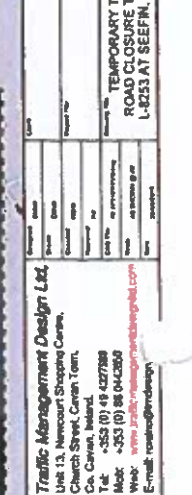
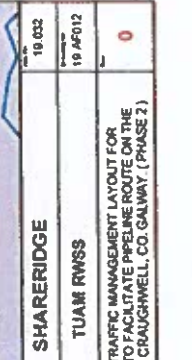
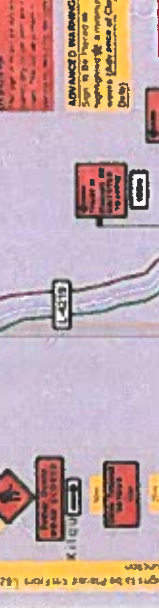
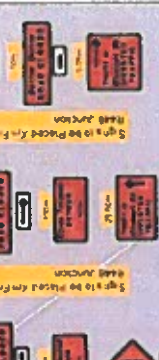
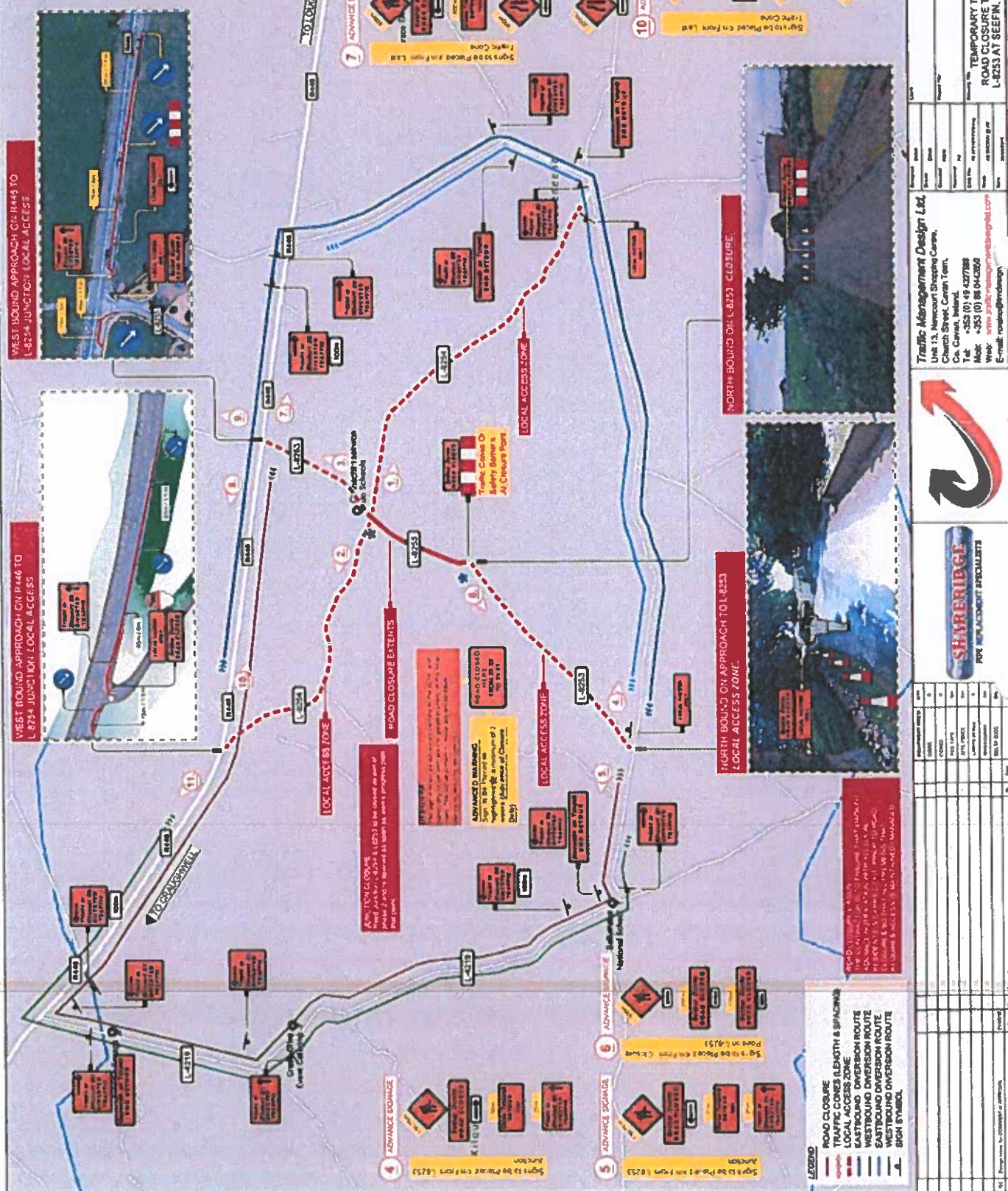